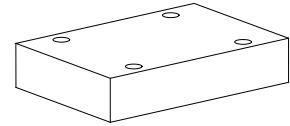

Blanking plate
Linking plate
 • $p_{max} = 350 \text{ bar}$

NG10
 ISO 4401-05

DESCRIPTION

Blanking and linking plates NG10 acc. to ISO 4401-05. The plates are zinc coated and will be supplied inclusive 5 O-rings ID 14,00x1,78 (article 160.2140). The connections T and To are connected together.

APPLICATION

Blanking plates are used to seal all ports (P, A, B, T, T0) of a NG10 interface. With linking plates selected ports of a NG10 interface can be connected. Other ports not in use are sealed.

TYPE CODE

	A BP 10	#	<input type="checkbox"/>
	A U 10 /	#	<input type="checkbox"/>
International standard interface ISO			
Blanking plate	BP		
Linking plate	U		
Nominal size 10			
Connection of ports see type code list and symbols			
Design-Index (Subject to change)			

DIMENSIONS

Blanking and linking plate

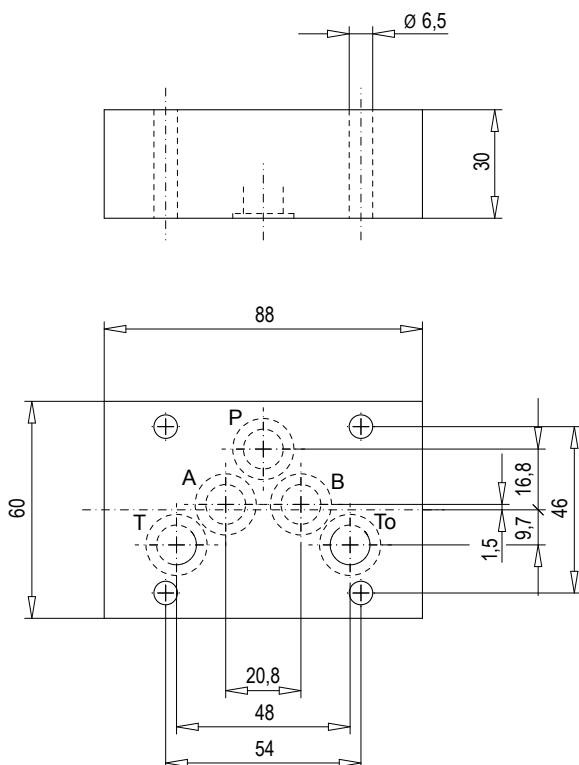
TYPES

Types	Article no.	Symbols
<i>Blanking plate:</i>		
ABP10	173.4150	A P T B
<i>Linking plate:</i>		
AU10 / P-B / A-T	173.4250	A P T B
AU10 / P-A / B-T	173.4251	A P T B
AU10 / P-A	173.4252	A P T B
AU10 / P-B	173.4253	A P T B
AU10 / P-T	173.4254	A P T B
AU10 / A-T	173.4255	A P T B
AU10 / B-T	173.4256	A P T B
AU10 / A-B-T	173.4260	A P T B
AU10 / A-B	173.4257	A P T B
AU10 / P-A-B	173.4258	A P T B